

Third / Fourth Floor / Europe Hall – Side Loges – Balcony

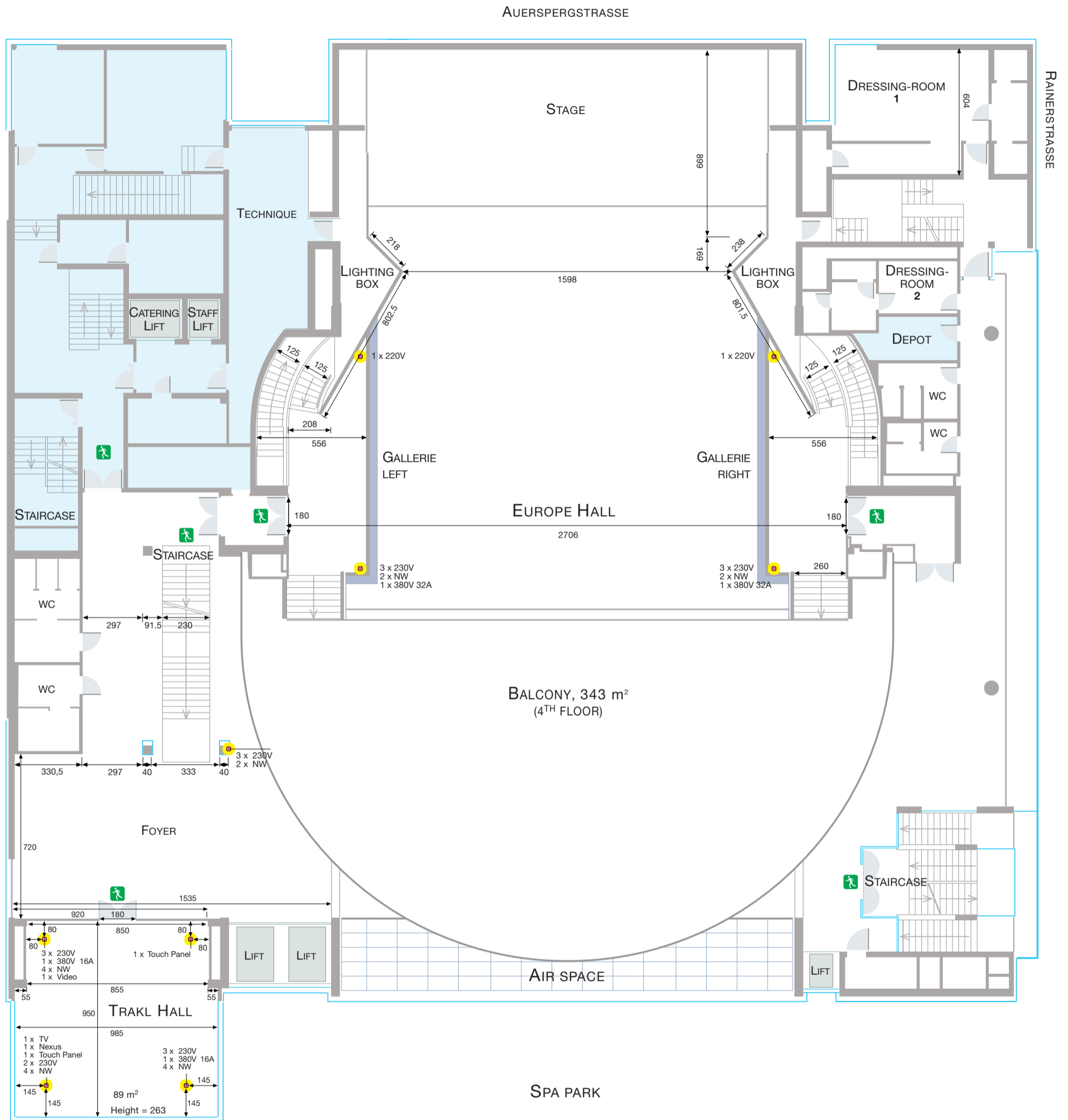

0 50 100 200 300 400 500 cm

CAPTION
 Nexus = Audiosystem link
 Touch Panel = On-site handling of light, fade-out, shading, silver screens (if present)
 NW = Network, analog, ISDN, V-Lan, dedicated line
 IR = Cabling for infrared heating element
 Red flash light BMZ = Fire detector flash light
 TV-Antenna = TV and Radio Link
 Bottom tank = WW and CW supply and drain

60 Lengths specifications in centimetre
 Floor outlet
 Mobile walls
 Fixed walls
 Closed area

Status: 05/2008